

WEDGE ANCHOR INSTALLATION RECOMMENDATIONS



1 800 716 5506 | maglin.com



INSTALLATION STEPS

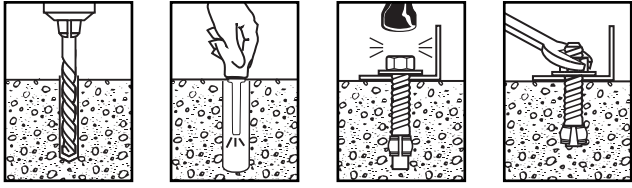

1. Place Maglin product in desired location. Mark hole locations with pencil or marker. Set product aside taking care not to scratch coatings.
2. Select a $\frac{3}{8}$ " diameter carbide or masonry drill bit. Drill hole to depth exceeding the desired embedment.
3. Clean hole or continue drilling additional depth to accommodate drill fines.
4. Assemble washer and nut, leaving nut flush with end of anchor to protect threads. Drive anchor into concrete leaving enough thread exposed to accommodate the thickness of the washer, nut and product mounting plate. Remove washer and nut from anchor and install Maglin Product.
5. Replace washer and nut. Expand anchor by securing the nut past the hand tight position, being careful to avoid cracking paint.
6. Additional thread protruding beyond the nut may be cut off and removed.

WARNING!

- ⚠ **Use in concrete ONLY.** Not recommended for use in lightweight masonry such as block or brick.
- ⚠ Always wear safety glasses and other necessary protective devices or apparel when installing or working with anchors.

CAUTION:

Use of core drills is not recommended to drill holes for use with this anchor.

Not recommended for use in new concrete which has not had sufficient time to cure.

The use of carbide drill bits manufactured within ANSI B212.15 drill bit diameter requirements is recommended for installation of this anchor.

Anchor spacing and edge distance requirements (anchor installation locations) are the responsibility of the engineer of record.

NOTE: Local/Regional codes should be researched prior to installation

WARRANTY:



Two or more people are required for installation. Please ensure that products are not dragged on concrete or other hard surfaces that will scratch the outside layers of protective coatings.

When installing anchor bolts, provide care that bolts are not fastened so tightly that protective coatings become cracked.

For complete care and maintenance and warranty policy, visit the Maglin Site Furniture website www.maglin.com.



MAGLINTM
Site Furniture